

측면도
(단부지주)

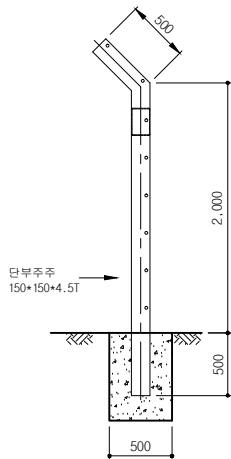

흡파이프형 낙석방지책(KD-NS-08)

정면도

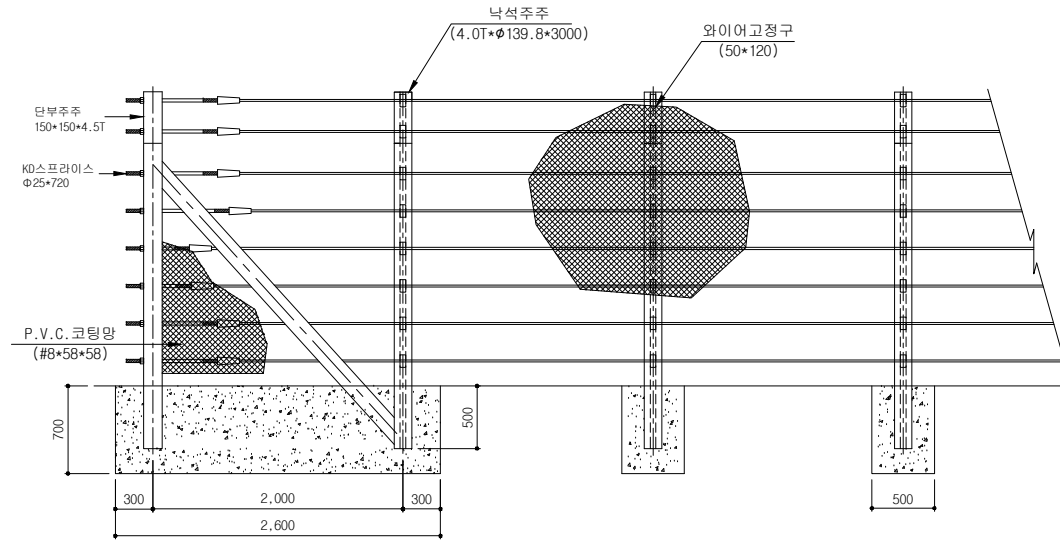

측면도
(중간지주)

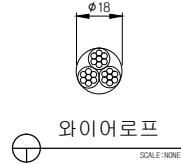
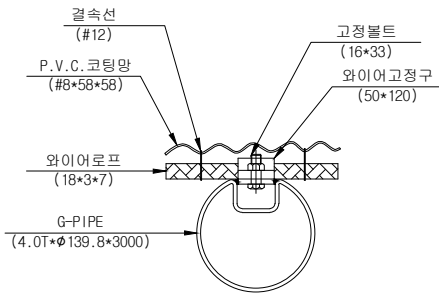
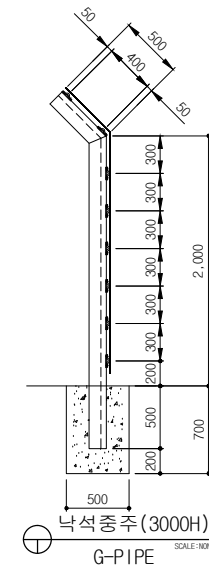

철망과 와이어로프 결속

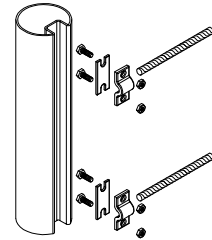

와이어고정구사시도

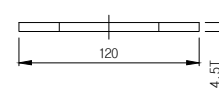
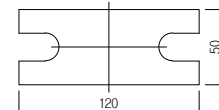
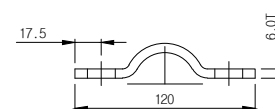
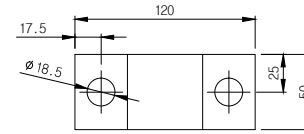

와이어고정구

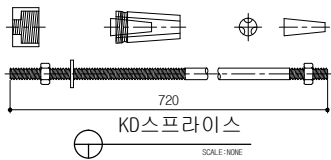

KD스프라이스

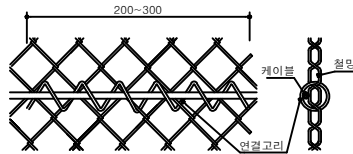

주) 상기도면은 현장 실무자의 이해를 돕기 위하여 낙석대책기술(일본)의 자료를 인용한 것임.

표준구간(경간당)

품명	규격	단위	수량	비고
낙석중주	4.0T*139.8*3000	본	1	용량도금
PVC코팅망	#8*58*58	m ²	5.0	PVC코팅
와이어로프	φ18*3*7	M	16	용량도금
와이어고정구	50*120	조	8	용량도금
고정B/N	φ16*33	SET	16	용량도금
결속선	#12	KG	0.2	PVC코팅
랩	φ139.8	EA	1	용량도금

단부구간(개소당)

품명	규격	단위	수량	비고
낙석단부(조립단부)	150*150*4.5*3000	조	1	용량도금
PVC코팅망	#8*58*58	m ²	5.0	PVC코팅
와이어로프	φ18*3*7	M	16	용량도금
결속선	#12	KG	0.2	PVC코팅
KD스프라이스	25*720	조	8	용량도금
단부 B/N	φ12*180	SET	4	용량도금

도면명
Drawing

낙석방지책
(흡파이프형)

설계
Design

날짜

도면번호

(주)금동강권

경남 밀양시 초동면 명성리 2467번지 초동농공단지 내

공사명
Project

제도
Drawing

축척

NON

KD-NS-08



TEL:055)-391-1717, FAX:055)-391-4600

도로안전시설물 전문 생산업체